

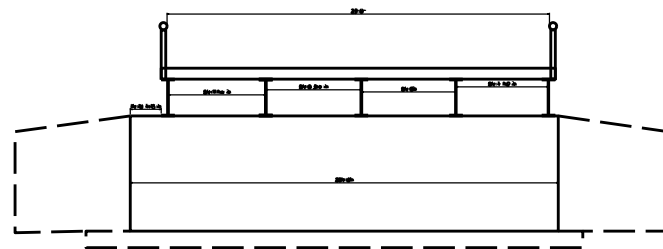

[illegible]

Right Side Sounding		BRIDGE NO.	
Left Side Sounding		23494	
ARKANSAS STATE HIGHWAY COMMISSION	Scale: 1"=8'	Drawn By:	Edit
Little Rock, ARK.	Inspection Dir: S to N	Channel Flow:	Edit
		Checked By:	Edit
		Date:	01/09/2019

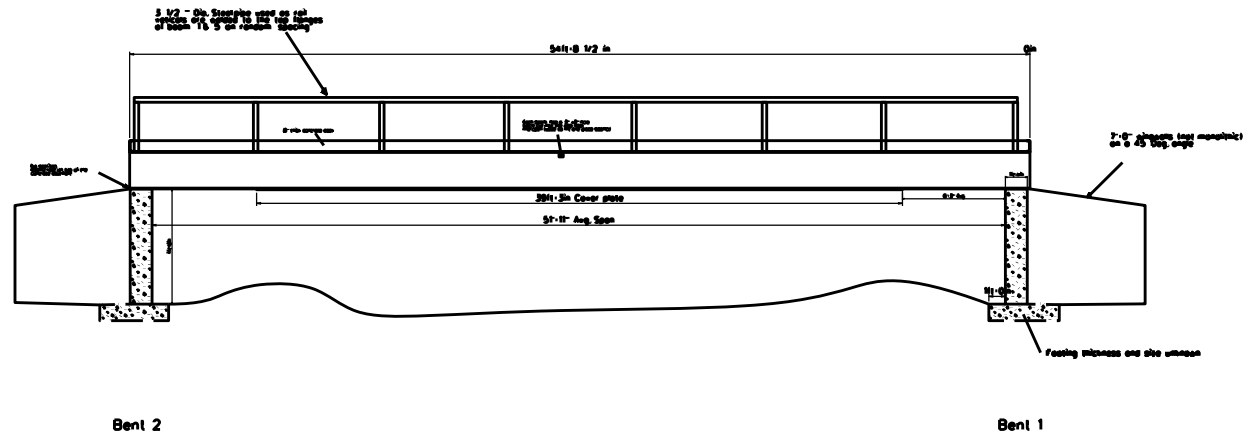

Channel Shape used  
as end of deck protection

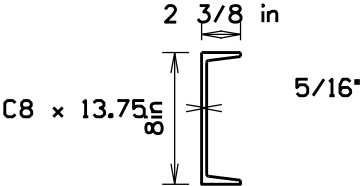

W27x84

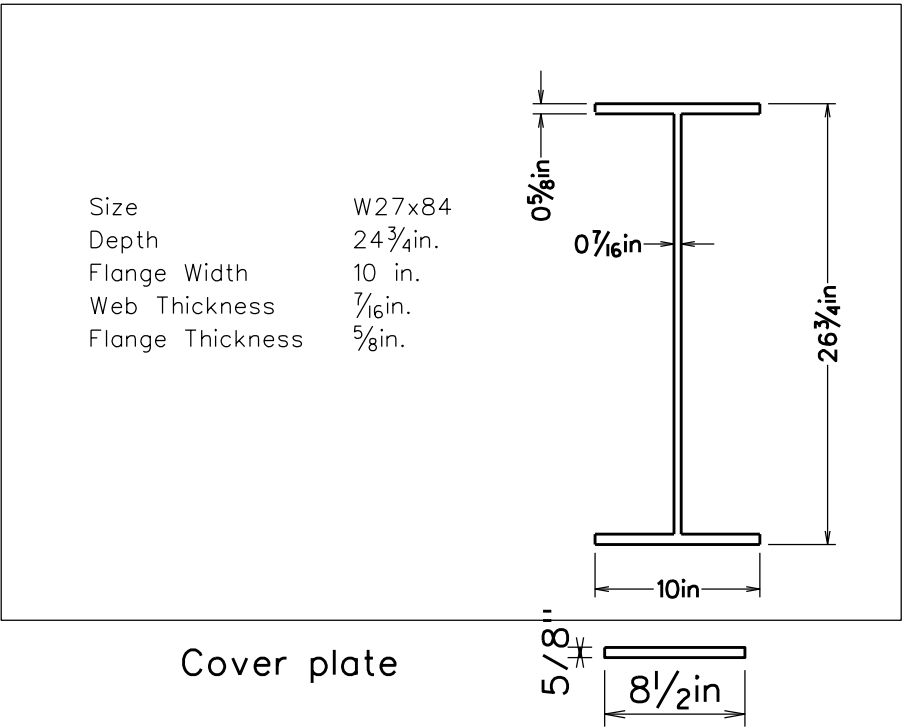

Steel Roofing used as  
S.I.P. forms between beams  
Gauge unknown

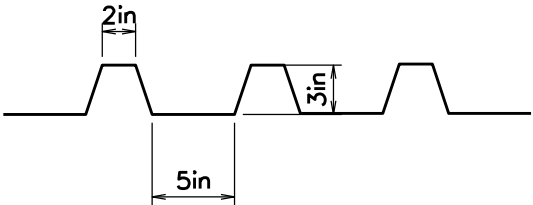

3 1/2 " Dia. Steel pipe used as rail  
verticals are welded to the top flanges  
of beam 1 & 5 on random spacing

54ft-8 1/2 in

0in

8" min concrete gap

Span over hole is 2'-2" max  
and gap used to fit over pipe beam!

7'-0" wingwalls (not monolithic)  
on a 45 Deg. angle

See drawing  
for details on top of the  
structure

39ft-3in Cover plate

6'-2" long

51'-11" Avg. Span

High

1ft-0in

Footing thickness and size unknown

Bent 2

Bent 1

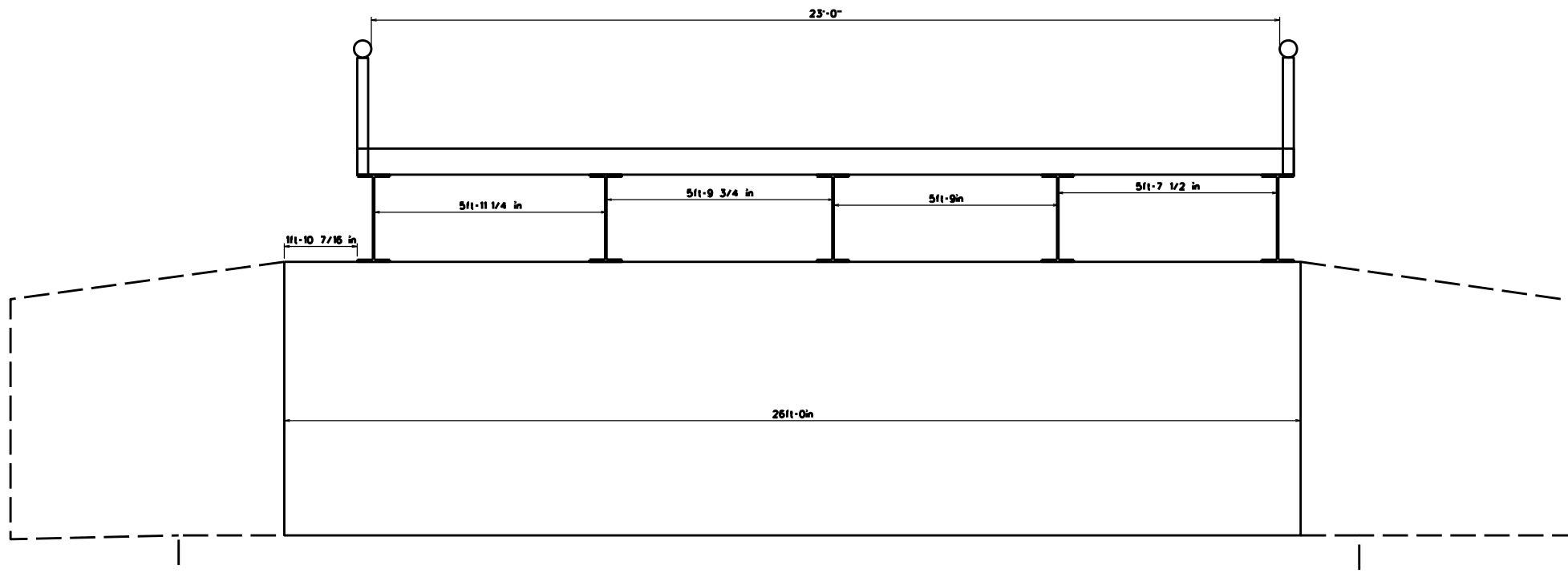

Cross Section at Bent 1, Looking Ahead  
Beam Spacings are center to center